



MAKE ELECTRICAL CONNECTION EASIER AND MORE SAFE



**CONWELL**<sup>®</sup>  
ZHEJIANG KEYI ELECTRIC GROUP CO.,LTD

Add : 1#, Yonghe 2nd road, Chengdong industrial zone, Chengdong street, Yueqing, Zhejiang, China  
Tel : +86-577-57179938  
Mob : +86-13968801432 / +86-13695811566  
Email : conwellky@conwell.cc  
Web : www.conwell.cc

**CONWELL**<sup>®</sup>  
ZHEJIANG KEYI ELECTRIC GROUP CO.,LTD



# COMPANY PROFILE

Zhejiang Keyi Electric Group Co.,Ltd., founded in 2004, is located in chengdong industry zone Yueqing, Zhejiang province,China. It is a hi-tech enterprise specialized in designing and producing insulation piercing connector, anchorclamp, suspension clamp, waterproof box and other connecting accessories according to NFC, IEC, EN, UL standards. Besides, it has achieved ISO9001 Quality Management system, ISO14001 environmental management system, OHSAS18001 occupational health and safety management system, CE, ROHS and other certificates, as well as many invention and utility model patents in China.

With 15 years development and research, it has more than 200 kinds of products for low voltage electrical power system. For example:

- |                                  |                              |                                 |
|----------------------------------|------------------------------|---------------------------------|
| 1. Insulation piercing connector | 2. Anchor clamp              | 3. Optical Cable Accessories    |
| 4. Suspension clamp              | 5. Parallel groove connector | 6. Waterproof box & Accessories |
| 7. Lightning protection products | 8. Pre-insulated sleeve, lug | 9. Bimetal lugs                 |
| 10. Other ODM products           |                              |                                 |

We especially have advantage on OEM and ODM of all metal and plastic power connection accessories.

We devote to providing full range of product chain and solution.

Quality management system: test strictly done by ISO, EN UL and other relative standard.

It has a lab(city-level technology research and development center) with full testing facilities.

# HONORARY CERTIFICATE



# SCIENTIFIC RESEARCH



**OFFICE ENVIRONMENT**



[www.conwell.cc](http://www.conwell.cc)



**PRODUCTION WORKSHOP**



# CONTENT

<b>Insulation Piercing Connector</b>	<b>Page</b>
▪ 1KV 1 Bolt Insulation Piercing Connector	02
▪ 1KV 2 Bolt Insulation Piercing Connector	03
▪ 1kv Customized Insulation Piercing Connector	04
▪ CD Series Insulation Piercing Connector	04
▪ TTD Series 1KV Insulation Piercing Connector	05
▪ 10KV Insulation Piercing Connector	06
▪ 20KV Insulation Piercing Connector	06

<b>Anchor Clamp,Suspension Clamp &amp; Bracket</b>	<b>Page</b>
▪ Anchor Clamp	10-11
▪ Optical Fiber Clamp	12-14
▪ NLL Series Metal Wedge Clamp	15
▪ NUT Type Adjustable Clamp	15
▪ Suspension Clamp	16
▪ Bracket & Link Fitting	17

<b>Joint Resin Kits</b>	<b>Page</b>
▪ 4 Core Piercing Connector	19
▪ Joint Resin Kits	20

# CONTENT

<b>Cable Fitting</b>	<b>Page</b>
▪ H Clamp C Clamp JXD Clamp	22
▪ Parallel Groove Clamp	23-25
▪ Pre-insulated Bimetal Lugs	26-27
▪ C Type Copper Connecting Clamp	28
▪ DTL Series Bimetal Cable Lugs	29-30
▪ Stainless Steel Strap & Cable Ties	31-34

<b>Surge Arrester &amp; Insulator</b>	<b>Page</b>
▪ Surge Arrester	36
▪ Insulator	37

<b>Waterproof Junction Box</b>	<b>Page</b>
▪ KW-RA/RT Series Plastic Junction Box	39
▪ KW-F Series Plastic Junction Box	40
▪ KT Series Plastic Junction Box	41-42

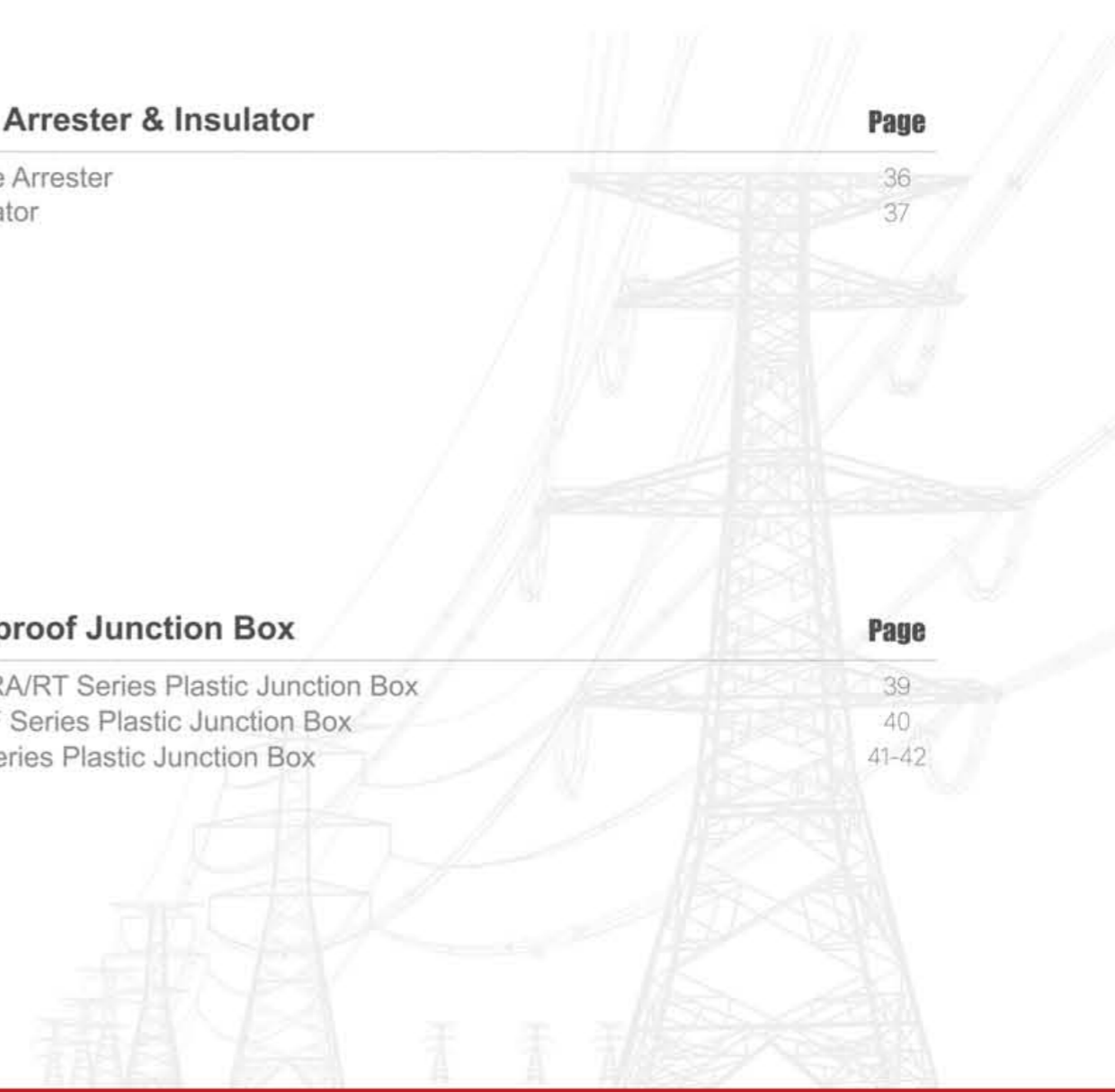

# Insulation Piercing Connector



## Insulation Piercing Connector

### 1KV 1 Bolt Insulation Piercing Connector

- According to EN50483 standard,
  - Strong PA66 cover with 1.5 times torque force testing without problem.
  - High hardness al alloy or cu teeth with tin plated.
  - Stable shear head force keep  $\pm 1\text{Nm}$ .
  - Same hardness of nut and bolt thread, prevent from thread broken.
  - UV protected plastic.
  - Hot dip, dacromet or chroming galvanization, prevent from oxidation and corrosion.
  - Some type can be used for underwater of 6kv withstand voltage, and compact structure of PVC or rubber lining with teeth and body to prevent from leakage.



Type	Equivalent Type	Main Line Section (mm <sup>2</sup> )	Branch Line Section (mm <sup>2</sup> )	Norminal Current (A)	Torque(Nm)
KW756	JJC888	0.75-6	0.75-6	41	/
KW101	JJC-1	1.5-25	1.5-16	55	10
KWEP	JJC-2	16-95	1.5-16	55	10
KW102	JJC-3(B)	6-70	4-25	157	15
KW2-95	JJC-3	16-95	4-35(50)	157	20
JBC-2	/	35-70	6-35	120	23-25
KW2-150	JJC-4	50-150	6-50	157	20
KW2-150T	/	16-150	4-50	/	15
KW3-95	JJC-5	25-95	25-95	214	20
KW4-150	JJC-6	35-150	35-150	316	26
KW4-150A	/	35-150	35-150	316	26
KW4-150B	/	16-150	16-150	316	26
KW6	/	120-240	25-120	276	35
KW7	/	150-240	10-25	102	35

◎ **1KV 2 Bolts Insulation Piercing Connector**

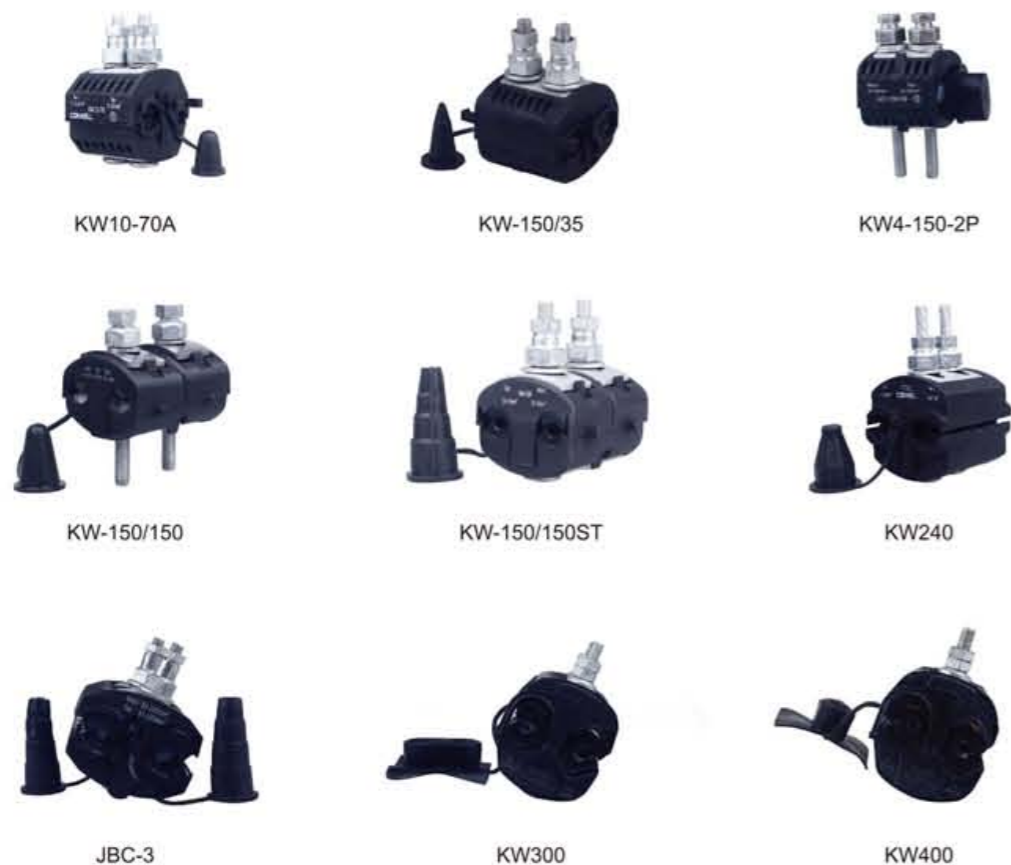

Type	Main Line Section (mm <sup>2</sup> )	Branch Line Section (mm <sup>2</sup> )	Normal Current (A)	Torque
KW10-70A	16-95	4-70	180	18
KW-150/35	16-150	16-150	316	18
KW4-150-2P	16-150	16-150	316	26
KW-150/150	35-150	35-150	316	20
KW-150/150ST	35-150	35-150	316	20
KW240	95-240	95-240	425	32
JBC-3	50-240	50-240	425	23-25
KW300	300	/	425	35
KW400	400	/	425	35

◎ **1kv Customized Insulation Piercing Connector**



Type	Main Line Section (mm <sup>2</sup> )	Branch Line Section (mm <sup>2</sup> )	Normal Current (A)	Torque
KWHP	16-95	1.5-16	55	10
KWFS-95/50	16-95	4-50	157	15
ELU-1	25-95	25-95	214	/
KWLW-1	35-70	16-35	120	15
KWLW-2	50-120	35-70	180	15

◎ **CD Series IPC**



Type	Main Conductor Cross-Section (mm <sup>2</sup> )	Tap Conductor Cross-section (mm <sup>2</sup> )
CD21	10-25	2.5-35
CD71	35-95	4-54
CD72	35-95	2*4-54
CD150-1P	16-150	1.5-95
CD150-2P	16-150	2*1.5-95
CD150-4P	16-150	4*1.5-95
CD71 (naked cable)	35-95	4-54
CT295-2	35-95	2.5-35
CT295-3	35-95	2*2.5-35

● **TTD Series 1KV Insulation Piercing Connector**

- Insulation piercing connector property: It is mainly used for branch connection, succession and grounding protection for 20kV,10kV and 1kV or below :
  1. Simple installation: Put the main wire and the branch wire directly on the right place without wire stripping. Tighten the shear head evenly by wrench.
  2. Low resistance and low temperature-rise: The special bolts can ensure equal piercing pressure for superior electric contact and less wire damage, so that make sure the normal service life of the pierced wire.
  3. Sealing structure with good insulation: tight insulated lining and enough compound to ensure the insulation function in good control when connector used outdoors.
- Notice: 1.The conductors for installation should be under the connector range.  
2.Put on insulated gloves, use insulated wrench during installation.  
3.Do not re-use it after dis-assembly as its non-renewable character.



Type	Main Line (mm <sup>2</sup> )	Branch Line (mm <sup>2</sup> )	Max Current (A)	Bolt size		Torque nut
				Quantity	H(mm)	
TTD041FJ	6-35	1.5-10	86	1*M8	13	F1309
TTD051FJ	16-95	1.5-10	86	1*M8	13	F1309
TTD101FJ	6-50	2.5(6)-35	200	1*M8	13	F1314
TTD151FJ	25-95	2.5(6)-35	200	1*M8	13	F1314
TTD201FJ	35-95	25-95	77	1*M8	13	F1318
TTD251FJ	50-150	25-95	377	1*M8	13	F1318
TTD271FJ	35-120	35-120	377	1*M8	13	F1318
TTD281FJ	50-185	2.5(6)-35	200	1*M8	13	F1314
TTD401FJ	50-185	50-150	504	2*M8	13	F1318
TTD431FJ	70-240	16-95	377	2*N8	17	F1720
TTD441FJ	95-240	50-150	504	2*M10	17	F1725
TTD451FJ	95-240	95-240	530	2*M10	17	F1725
TTD551FJ	120-400	95-240	679	2*M10	17	F1737

● **10KV Insulation Piercing Connector**



KW10-240/150

KW10-240/240

Type	Cable Size (mm <sup>2</sup> )		Cable Diameter (mm <sup>2</sup> )		Current(A)
	Main Line	Branch Line	Main Line	Branch Line	
KW10-95/70	25-95	16-70	φ15.8-φ21.4	φ12.6-φ19.8	180A
KW10-120/70	25-120	25-70	φ15.8-φ22.8	φ15.8-φ19.8	180A
KW10-185/50	95-185	16-50	φ21.4-φ26.2	φ12.6-φ18.1	148A
KW10-240/150A	95-240	50-150	φ21.4-φ28.4	φ18.1-φ24.6	280A
KW10-240/240	95-240	95-240	φ28.4	φ28.4	376A

● **20KV Insulation Piercing Connector**



KW20-240/240

Type	Cable Size (mm <sup>2</sup> )		Cable Diameter (mm <sup>2</sup> )		Current(A)
	Main Line	Branch Line	Main Line	Branch Line	
KW20-240/95	50-240	50-240	/	/	220A
KW20-240/240	50-240	35-95	φ20.5-φ30.6	φ20.5-φ30.6	376A



● **General of Insulation Piercing Connector (ipc)**

- 1.Piercing connector, simple installation, need not strip the cable coat.
- 2.Moment nut, piercing pressure is constant, keep good electric connection and make no damage to lead.
- 3.Self-seam frame, waterproof, wet proof, and anti-corrosion, extend the using life of insulated lead and connector.
- 4.Adopted special connecting tablet, apply to joint of Cu (Al) and Cu (Al) or Cu and Al.
- 5.Small electric connecting resistance,connecting resistance less than 2.5 times of the resistance of branch.
- 6.Special insulated case body, resistance to illumination and environmental aging, the insulation strength can up to 12kv.
- 7.Arc Surface design, apply to connection with the same (different) diameter, wide connection scope (0.75mm<sup>2</sup>-400mm<sup>2</sup> / td)

● **Performance Testing**

- 1.Mechanical performance: the grip force of the wire clamp is 1/10 bigger than the break force of the lead, it comply with GB2314-1997
- 2.Temperature rise performance: under the condition of big current, the temperature rise of connector is less than that of connection lead.
- 3.Heat circle performance: conforms to GB/T2317.3-2000, the heat circle trial standard for electric fitting.
- 4.Waterproof insulation performance: conforms to the relevant testing requirements in part 2 of GB/T13140.4-1998.
- 5.Resistance to corrosion performance: under the condition of SO<sub>2</sub> and salt fog, it can do three times of fourteen days circle testing.
- 6.Environmental aging performance: under the circumstance of ultraviolet, radiation, dry and moist, expose it with change of temperature and heat impulse for six weeks.
- 7.Fire-proof performance: insulation material of the connector withstands glowing filament test. Conform to the requirement in chapter 4-10 of GB/T5169.4



● **Installation Insulation Piercing Connector**

- 
- 1.Adjust the connector nut to suitable location.
  - 2.Put the branch wire in to the cap sheath fully.
  - 3.Insert the main wire, if there are two layers of insulated lay in the main cable, should strip a certain length of the first insulated lay from inserted end.
  - 4.Turn the nut by hand, and fix the connector in suitable location.
  - 5.Screw the nut with the sleeve spanner.
  - 6.Screw the nut continually until the top part is cracked and dropped down.

● **Typical Application**



# Anchor Clamp, Suspension Clamp & Bracket



## Anchor Clamp, Suspension Clamp & Bracket

### ⦿ Metal Anchor Clamp

- They are characterized by high mechanical stability, reduced dimensions for easier handling, high mechanical and climatic resistance.
- They are in accordance with NFC-041.



Type	Cross-section (mm <sup>2</sup> )
PAL1000A	16-35
PAL1000	25-35
PAL1500	50-70
PAL2000	70-150
PAL90-1500	50-95
PA2/35	2*16-35
PA4/35	4*16-35
KW160	2*16-35
KW161	4*16-35
PA4/16-35	2*16/4*35
KW116	4*16-70
NES-1B	4*16-70
NES-2B	4*70-120

● **Plastic Anchor Clamp**

- The body is made of UV resistant, glass fiber reinforced synthetic material.
- The handle and the hook have good corrosion resistance.
- All of the elements are captive.



Type	Cross-section (mm <sup>2</sup> )
PA16	10-16
PA25	6-25
PA50	16-35
PA70	25-70
PA16-95W	2*16-95
PA2/25	2*16-25
PA4/25	4*16-25
PA4/50	4*16-50
PA435A	4*16-35
PA4/6-35	4*16-35

● **ADSS Anchor Clamp**

Picture	PA300	PA500	PA1000	PA1500
Model	PA300	PA500	PA1000	PA1500
Cable Diameter (mm)	4-8	4.5-9	8-11	11-14
Break Load (kN)	3.5	6	10	15
Weight (g)	133	199	364	354

● **Fiber Optic Suspension Clamp**

Picture	HC-5-8	HC-8-12	HC-10-15	HC-12-20
Model	HC-5-8	HC-8-12	HC-10-15	HC-12-20
Cable Diameter (mm)	5-8	8-12	10-15	12-20
Break Load (kN)	4	4	4	4
Weight (g)	194	160	/	/

Picture	CS	D6	SSA	ZP-8-2
Model	CS	D6	SSA	ZP-8-2
Cable Diameter (mm)	4-5/5-9	4-8	4-5/5-9	4-8
Break Load (kN)	8	0.3	8	2
Weight (g)	219	12	119	85

◎ Tension Clamp for Figure 8 Cable



Model		PA05	PA06	PA07	PA08	PA09	PA37	PA69
Cable Diameter	(mm)	2.5-5	≤6	≤7	≤7	≤10	3-7	6-9
Break Load	(kN)	2	3	5	5.5	8	2	2
Weight	(g)	79	96	151	160	339	131	128

◎ Tension Clamp for FttH Cable



Model		ODWAC-15	ODWAC-22	ODWAC-26	ACC	S-Type	C350	C360
Break Load	(kN)	0.7	1.2	1.2	2	1	0.9-1	/
Weight	(g)	25	42	/	45	29	23	38

◎ Application



◎ ADSS Connecting Clamp & Bracket



● **NLL Series Metal Wedge Clamp**



Type	Cable Diameter	Breaking Load	U Bolt Qty
	(mm)	(kN)	
NLL-1	5.0-15.5	60	2
NLL-2	8.5-19.6	60	2
NLL-2A	8.0-15	60	2
NLL-2B	8.0-15	60	2
NLL-3	11.4-22.6	80	2
NLL-3A	11.4-22.6	80	3
NLL-4	13-26.4	80	3
NLL-4A	13-26.4	81	3
NLL-1G	5-16	40	2
NLL-2G	5-21	10	3

● **NUT Type Adjustable Clamp**

- NLL series bolt type aluminum alloy strain clamp is applicable to 35kV and below aerial circuits. To fix aluminum stranded conductor or steel core aluminum stranded conductor. For matching insulating aluminum cover when using aerial insulating aluminum conductor, for insulating safety action.

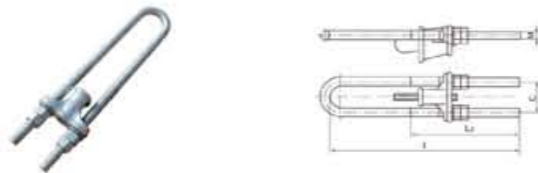

Type	Steel Wire Dia	Dimensions (mm)				Rated failure load	Weight
	(mm)	C	M	L	L1	(kN)	(KG)
NUT-1	6.6-7.8	56	16	350	200	45	2.1
NUT-2	9.1-11.0	62	18	430	250	88	3.2
NUT-3	13.0-14.0	74	22	500	300	143	5.4
NUT-4	15.0-16.0	82	24	580	300	164	7.2

● **Suspension Clamp**

- - The body is made of UV resistant, glass fiber reinforced synthetic material.
- - The insulated neutral messenger is secured by the notched tightening lever.
- - It is used for suspending the low voltage A.B.C.(Aerial bundled conductors)



Type	Cross-section (mm <sup>2</sup> )
KW94	16-95
KW95	16-95
1.1A	16-95
1.1B	25-95
1.1C	25-95
ES1500	25-95
PS1500	25-95
PS435	4x16-35
PS470	4x50-70
PS4120	4x95-120
PSP25-120	4*25-120

• **Bracket**

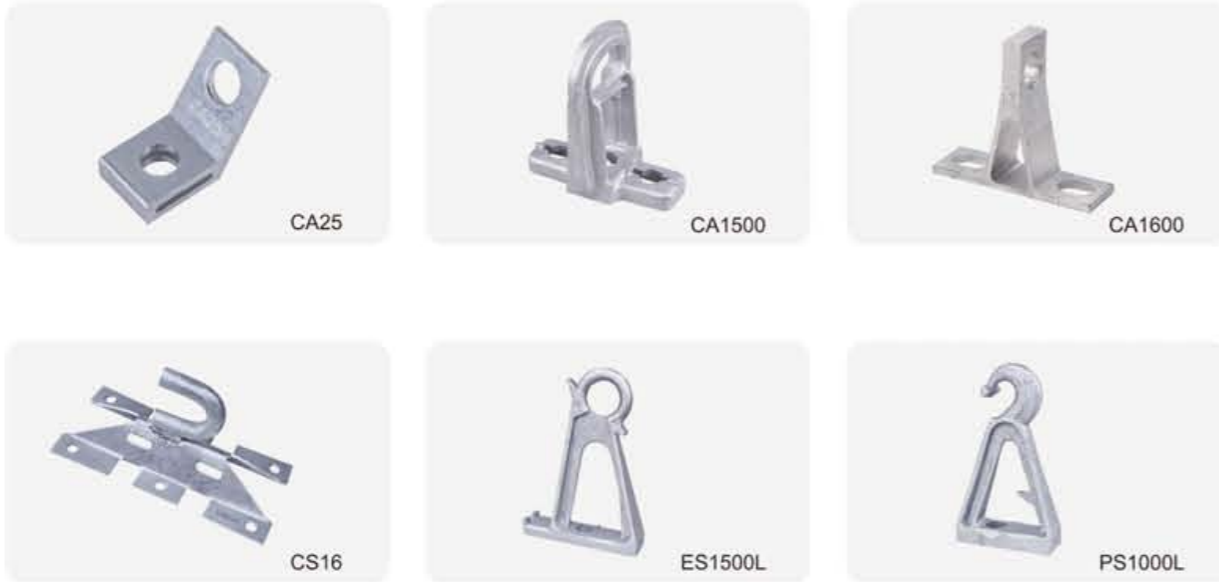

• **Link Fitting**



# Joint Resin Kits



◎ **4 Core Piercing Connector**

● **Usage and cautions**

- Using tool to divide cables, then put wedge into it
- Adjust 4 cores connector on right position, use hexagon spanner to make 2 AL part floded
- Get branch cable into branch outlet, then fasten clock wisely
- Assembling finished, put into waterproof junction box.

- Four core piercing connector is mainly applied to high current trunk to branch, the main cable insulation without stripping, one connector can quickly branch to four extension, almost no space is occupied, the shell is made of aluminum parts, high ultimate strength, reusable, it is superior than the cable piercing puncture connector.

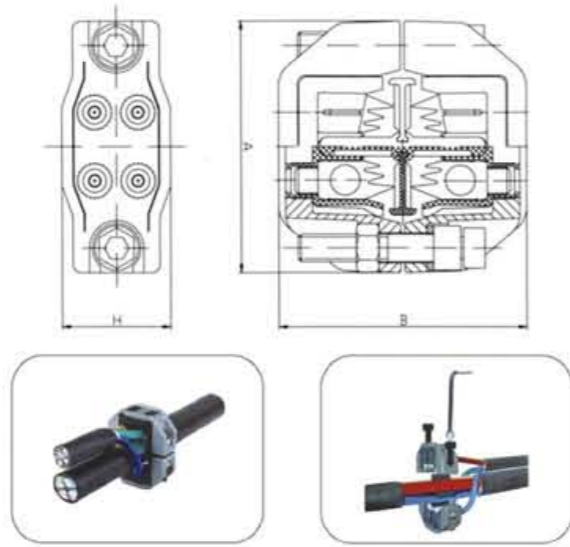

Type	Main Section(mm²)		Branch Section(mm²)	
	Strand Cable	Solid Core Wire	Strand Cable	Solid Core Wire
GHFC-1	50-70	70-95	6-50	6-70
GHFC-2	70-120	95-150	6-50	95-150
GHFC-3	95-120	120-150	Fan-shaped:35-120 Circle:10-95	Fan-shaped:50-100 Circle:16-120
GHFC-4	150-185	150-240	6-70	6-70
GHFC-5	185-240	/	6-70	6-70



◎ **Joint Resin Kits**

● **Direct Connection Style**

Item NO.	Cable Insulation O.D Range (mm)	Max Conductor Section (mm²)				Specification(cm)
		unarmored cable		armored cable		
KW-A1	8-26	3*16	4*16	3*10	4*10	185*40*45
KW-A2	14-32	3*35	4*25	3*35	4*16	270*55*55
KW-A3	23-39	3*50	4*50	3*50	4*35	355*65*60
KW-A4	28-50	3*95	4*95	3*95	4*70	400*90*75
KW-A5	33-60	3*185	4*95	3*185	4*120	485*220*180
KW-A6	45-77	3*300	4*300	3*300	4*240	485*220*180
KW-A7	45-90	3*240	4*240	3*240	4*240	485*220*180

● **Branch Connection Style**

Type	Cable Outer Diameter(mm)		Max.cross-section range(mm²)		Dimensions (mm)
	Main circuit	Branch circuit	Main circuit	Branch circuit	
KWBOX-1	Suitable for street light		2.5-3.5	1.5-10	70*45*28
KW-AB111	15	15	4*1.5-6	4*1.5-4	175*75*40
KW-AB112	22	21	4*6-10	4*4-10	175*110*76
KW-AB113	29	22	4*16-25	4*6-16	300*110*76
KW-AB114	35	25	4*35-70	4*16-25	400*125*100
KW-AB115	50	30	4*95-150	4*25-50	485*220*180
KW-AB116	58	35	4*120-185	4*35-70	485*220*180
KW-AB117	65	45	4*150-240	4*70-150	485*220*180
KW-AB118	27-55	16-36	4*35-150	4*6-70	295*175*130
KW-AB119	65	56	4*95-240	4*6-150	485*220*180



# Cable Fitting

## Cable Fitting

### ◎ H Clamp & C Clamp & JXD Clamp

#### ● Bolt Type C Clamp

Structure feature

- Made of non-magnetic material, no electric loss
- Wedge type resilient contact
- Easy installation and dismantle
- Able to cooperate with many kinds of conductor
- High flexibility, reusable, long service life

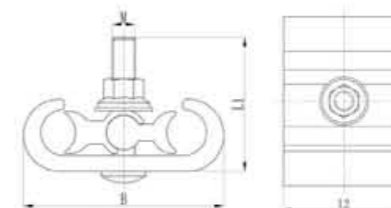

Type	Main Line (mm <sup>2</sup> )	Branch Lin (mm <sup>2</sup> )	Product Size(mm)			
			B	R	L	M
KY-81	300	185-300	105	12	15	12
KY-82	185-240	35-240	95	12	75	12
KY-83	120-185	25-150	76	10	52	10
KY-84	70-150	25-150	70	8	52	10
KY-85	25-95	25-50	65	6	52	10



#### ● JXD Wedge Clamp

Type	Main Line (mm <sup>2</sup> )	Branch Lin (mm <sup>2</sup> )	Product Size(mm)				
			L1	L2	L3	H1	H2
JXD-1	16-95	42	42	50.5	64	7	14
JXD-2	120-150	50	50	55.5	68.5	7	15
JXD-3	150-185	76	76.5	85.5	91	8	18.5
JXD-4	240	75	76	86.5	95.5	8	22

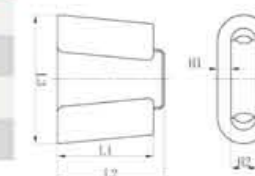

#### ● H Type Clamp

Type	Main Line	Branch Line	Dimensions (mm)			
	Diameter (mm)	Diameter (mm)	L	R1	R2	H
JH-1	4.8~8.2	4.8~8.2	38	5.3	5.3	17.3
JH-2	8.3~14	8.3~14	48	7.3	5.3	21.9
JH-3	10~14	10~14	60	7.3	7.3	21
JH-4	13~22.4	4.8~11.4	51	11	6.3	32
JH-5	13~22.4	11.6~16	51	11.3	8	32
JH-6	16.2~22.4	16.2~22.4	89	11.3	11.3	30.6

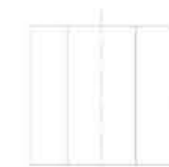
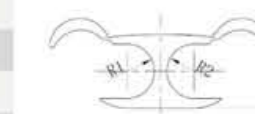



● **Parallel Groove Clamp**

● **JB Series Parallel Groove Clamp**

-Application:  
JBL,JBT,JB-TL series specific forms parallel groove clamp is suitable for unendure force splicing and branch on the aerial wire, being used with insulation cover . It's action is insulation protection.

-Structure Feature:  
Select oxidize-resistance aluminum alloy.  
All parts connected with each other, it can't lose parts during installation.  
An arc embraces the most part, conductor can't change.

Product Name	Type	Cross-section (mm²)
Aluminum Parallel Groove Clamp	JBL-6-35	6-35
	JBL-16-70	16-70
	JBL-35-120A	35-120
	JBL-35-120B	
	JBL-50-240A	50-240
	JBL-50-240B	
	JBL-120-400A	120-400
	JBL-120-400B	
Note:A - 2 Bolts, B - 3 Bolts		
Copper Parallel Groove Clamp	JBT-10-70	10-70
	JBT-35-120	35-120
	JBT-50-240	50-240
Bimetal Parallel Groove Clamp	JBTL-10-70	10-70
	JBTL-35-120	35-120
	JBTL-50-240	50-240



● **Railway dedicated Type PG Clamp**

Type	Cross-section (mm²)	Bolt Quantity
JBL-6-70	6-70	2
JBL-25-120	25-120	2
JBL-25-120	25-120	3
JBL-50-300	50-300	2
JBL-50-300	50-300	3

● **Al-Cu Bimetal PG Clamps**

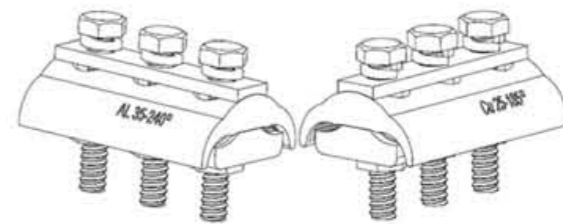
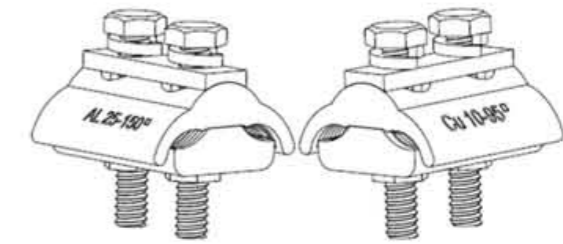
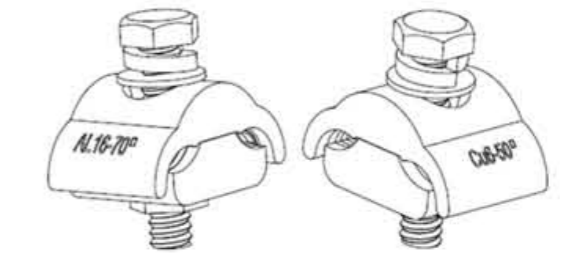

Type	Conductor cross-section (mm²)	Bolts
CAPG-A1	Cu6-50 Al16-70	1*M8
CAPG-A2	Cu10-95 Al25-150	1*M8
CAPG-B1	Cu6-50 Al16-70	2*M8
CAPG-B2	Cu10-95 Al25-150	2*M8
CAPG-B3	Cu25-185 Al35-200	2*M10
CAPG-C1	Cu6-50 Al16-70	3*M8
CAPG-C2	Cu10-95 Al25-150	3*M8
CAPG-C3	Cu25-185 Al35-240	3*M10
CAPG-C4	Cu35-240 Al35-300	3*M10

● **Aluminum Parallel Groove Clamp**

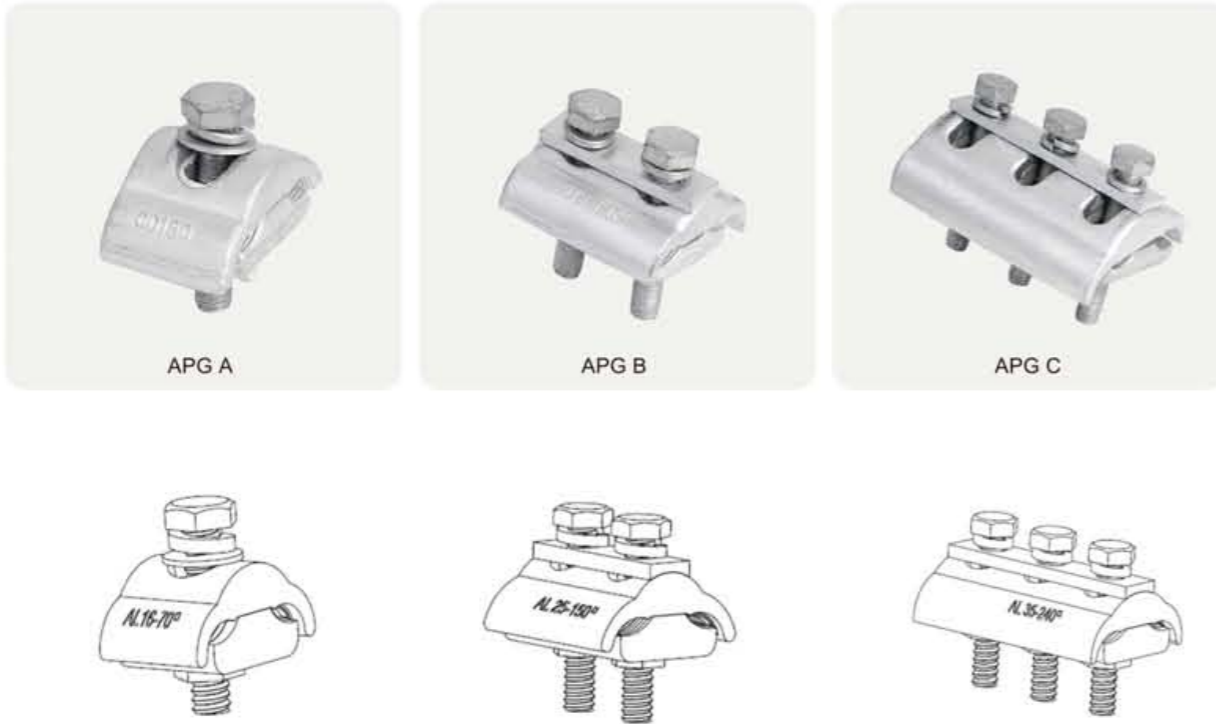

Type	Conductor cross-section (mm <sup>2</sup> )	Bolts
APG-A1	Al16-70	1*M8
APG-A2	Al16-150	1*M8
APG-B1	Al16-35	2*M8
APG-B2	Al16-70	2*M8
APG-B3	Al16-150	2*M8
APG-B4	Al25-185	2*M10
APG-C1	Al16-70	3*M8
APG-C2	Al16-150	3*M8
APG-C3	Al25-240	3*M10
APG-C4	Al35-300	3*M10

● **Pre-insulated Bimetal Lugs**

● **CPTAU Pre-Insulated Bimetal Lugs**

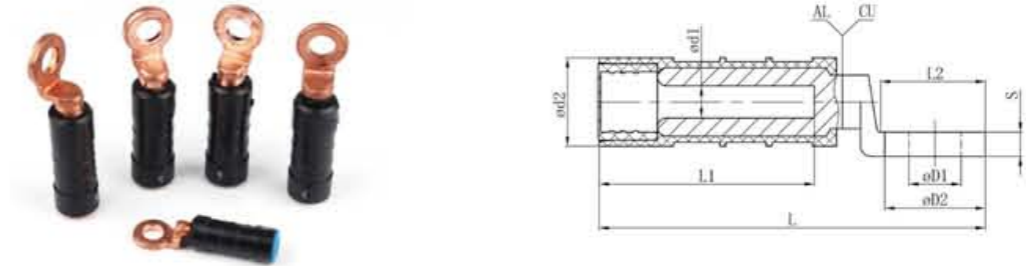

Type	Aluminium full length (mm)	Outer full Length (mm)	Copper head outer diameter (mm)	Dimensions(mm)					Color	Tool
				D1	D2	D3	D4	L		
CPTAU16	36	63	φ20	5.3	10.5	17.5	20	78	blue	E140
CPTAU25	36	63	φ20	6.5	13	22	25	97	orange	E173
CPTAU35	46	81	φ25	8	13	22	25	97	red	E173
CPTAU50	46	81	φ25	8.8	13	22	25	97	yellow	E173
CPTAU54	46	81	φ25	10	13	22	25	97	black	E173
CPTAU70	46	81	φ25	10.4	13	22	25	97	white	E173
CPTAU95	46	81	φ25	12.3	13	22	25	97	gray	E173
CPTAU120	60	121	φ42	14.2	13	27	30	123	pink	E215
CPTAU150	60	121	φ42	15.5	13	27	30	123	purple	E215

● **MJPB Pre-insulated Sleeve**

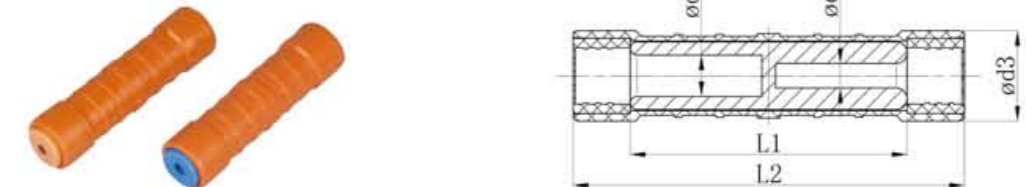

Type	Aluminium full length (mm)	Outer full Length (mm)	Dimensions(mm)				Color	Tool
			D1	D2	D3	L		
MJPB 16-6	48	70	3.3	4.3	19	70	brown/Green	E140
MJPB 16-10	48	70	4.3	5.3	19	70	Green/Blue	E140
MJPB 16-16	48	70	5.3	5.3	19	70	Blue	E140
MJPB 25-16	48	70	5.3	6.5	19	70	Blue/Orange	E140
MJPB 25-25	48	70	6.5	6.4	19	70	Orange	E140
MJPB 35-35	48	70	7.8	7.8	19	70	Red	E140

• **MJPT Pre-insulated Sleeve**

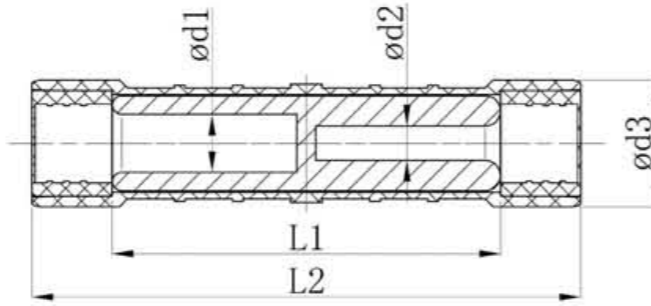

Type	Aluminium full length (mm)	Outer full length (mm)	Dimensions(mm)				Color	Tool
			D1	D2	D3	L		
MJPT35-35	73.5	100	7.8	7.8	23	105	Red	E173
MJPT50-50	73.5	100	8.8	8.8	23	105	Yellow	E173
MJPT70-70	73.5	100	10.5	10.5	23	105	White	E173
MJPT95-95	73.5	100	12.3	12.3	23	105	Gray	E173
MJPT120-120	110	140	14.2	14.2	28	105	Pink	E215
MJPT150-150	110	140	15.5	15.5	28	105	Purple	E215

• **MJPTN Pre-insulated Sleeve**

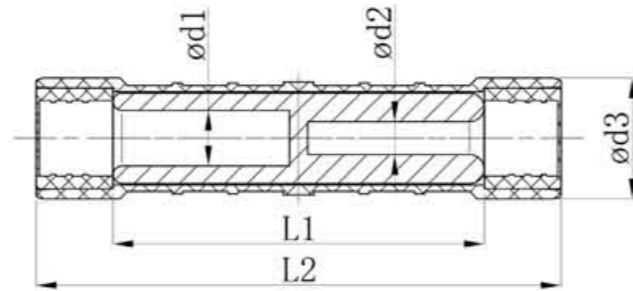

Type	Aluminium full length (mm)	Outer full length (mm)	Dimensions(mm)				Color	Tool
			D1	D2	D3	L		
MJPT 50N	140	170	8.8	8.8	24	175	Yellow	E173
MJPT 54,6N	140	170	10.4	10.4	24	175	Black	E173
MJPT 70N	140	170	10.5	10.5	24	175	White	E173
MJPT 95N	140	170	12.3	12.3	24	175	Gray	E173

• **C Type Copper Connecting Clamp**

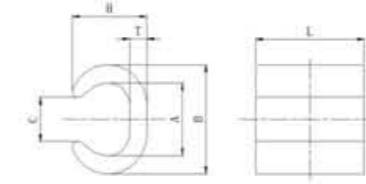

• **CCA Type**

Type	Cross-section (mm²)	Dimensions(mm)					
		H1	H2	W	L	T	C
CCA-1	16-16	22	17	11	12	2.5	5.8
CCA-2	16-25 16-35	20	15	13.5	22	3	8.3
CCA-3	25-25 25-35 35-35	24.7	16.7	14.5	22	4	9.4
CCA-4	16-50 25-50 35-50	27.8	20	17.5	23	6	10.3
CCA-5	16-70 25-70 35-70	26.7	20	17.5	23	4	11.7
CCA-6	25-95 35-95	31	23.5	19.5	25	5	13.2
CCA-7	50-50 50-70	34	21	21.5	24	8	10.8
CCA-8	70-70	34	26	21.5	25	7	11
CCA-9	70-95 95-95	37.4	26.3	21.7	29.5	6	14.5
CCA-10	70-150 95-150 70-185 95-185	46	34.7	30	30.5	7.5	19.6
CCA-11	95-120 120-120	42.6	31.5	25	29	7	16.6
CCA-12	150-150 185-185	54	39	31.7	32.5	9.8	19

• **CCT Type**

Type	Cross-section (mm²)	Dimensions(mm)					
		H1	H2	W	L	T	C
CCT-10	7.5-11	9.5	6.3	6.2	12	1.6	4
CCT-16	11.5-16	11.8	7.8	7.3	13	2	5
CCT-20	14-20	12.8	8.6	9.7	13	2.9	5.4
CCT-26	21-26	14.7	10.2	10.9	16	3.2	6.5
CCT-44	27-44	19	12.4	14.4	20	4	8.5
CCT-60	45-60	21	15.4	15.1	22	4	9.7
CCT-76	61-76	24.4	17.3	17.6	22	5	10.8
CCT-98	77-98	27.8	20.8	18.1	25	5	12.8
CCT-122	99-122	29.8	22.1	21.2	26	5.5	13.5
CCT-154	123-154	34	25.7	24.2	28	6	17
CCT-190	155-190	37	28.5	25.4	35	6	17.4
CCT-240	191-240	40	30.2	28.5	40	7	19
CCT-288	241-288	44.5	34.7	31.1	45	7	22.3
CCT-365	289-365	47.5	37.7	34	50	7	24.8
CCT-450	366-450	57	42.5	41	60	10	28
CCT-560	451-560	62	46	45	65	11	31
CCT-700	561-700	68	52	49.5	70	12	34

● **DTL Series Bimetal Cable Lugs**

- DTL Series of copper-aluminum bimetal cable lugs are suitable for transition connection of the circular aluminum wires, hemicycle-sector aluminum wires, power supply cables in the distribution equipment and copper terminals of the electrical equipment. The material of aluminum and copper is that of L3 and T2 respectively. It has the features of strong weld intensity, good nature in electrification, resistant galvanic corrosion and long service life.

● **DTL-1 Cable Lugs**

Type	Dimensions(mm)							
	Thread diameter	H	d	D	L1	W	S	L
DTL-16	8	8.4	5.5	10	32	16	3	70
DTL-25	8	8.4	7	12	34	18	3.5	75
DTL-35	10	10.5	8.5	14	40	20	3.5	85
DTL-50	10	10.5	9.5	16	42	23	4	90
DTL-70	12	12.5	12	18	47	26	4.5	102
DTL-95	12	12.5	13	21	50	28	5	112
DTL-120	14	14.5	15	23	53	30	5.5	120
DTL-150	14	14.5	16	25	55	34	6	126
DTL-185	16	16.5	18	27	58	37	6.5	133
DTL-240	16	16.5	20	30	60	40	7.5	140
DTL-300	20	21.0	23	34	65	45	8.5	165
DTL-400	20	21	26	38	70	52	9.5	170
DTL-500	/	/	29	42	75	60	10	190
DTL-630	/	/	34	54	80	78	10.5	225



● **DTL-2 Cable Lugs**

Type	Dimensions(mm)						
	L	L1	D3	d	S	D1	D2
DTL-2-16	82	42	16	5.5	3.5	20	10.5
DTL-2-25	82	42	16	6.5	3.5	20	10.5
DTL-2-35	82	42	16	8.2	3.5	20	10.5
DTL-2-50	92	43	20	9.7	4.5	25	12.8
DTL-2-70	92	43	20	11	4.5	25	12.8
DTL-2-95	92	43	20	12.5	4.5	25	12.8
DLT-2-120	114	59	25	14.5	5.5	30	12.8
DTL-2-150	114	59	25	16.5	5.5	30	12.8
DLT-2-185	126	59	32	17.5	6	35	12.8
DTL-2-240	126	59	32	19.5	6	35	12.8
DTL-2-300	130	60	34	23	6.5	36	12.8
DTL-2-400	155	90	40	26	7	36	17
DTL-2-500	155	90	40	29	7	36	17

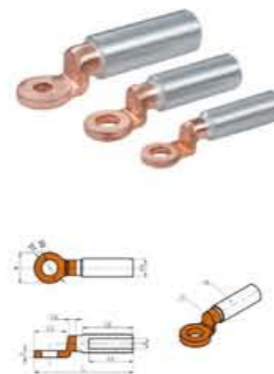

● **Aluminum Alloy Bolt Connector**



Type	Cable Size	Diameter of mounting hole		Dimensions			Bolt Qty.	AF
		LB	L1	L2	D1	D2		
BLMT-25/95-13	25-95	13	60	30	24	12.8	1	13
BLMT-35/150-13	35-150	13	86	35	28	15.8	1	17
BLMT-95/240-13	95-240	13	112	60	33	20	2	19
BLMT-120/300-17	120-300	17	115	65	37	24	2	22
BLMT-185/400-17	185-400	17	137	80	42	25.5	3	22

● **Aluminum Alloy Bolt Sleeve**



Type	Cable Size	Dimension		Bolt Qty.	AF2
		L1	D1		
BSMB-10/35	10-35	45	19	2	10
BSMB-25/95	25-95	65	24	2	13
BSMB-35/150	35-150	80	28	2	17
BSMB-95/240	95-240	125	33	4	19
BSMB-120/300	120-300	140	37	4	22
BSMB-185/400	185-400	170	42	6	22

● **Bolt Connector**

-It is suitable for the sequence and transportation of all kinds of conductor in electric netting, made of copper, brass, and copper plating.



Type	Dimension(mm)			
	L1	M	C	A
T/J-16	20	$\frac{1}{2}$ -20	6	14
T/J-25~35	36	$\frac{11}{16}$ -17	9	18
T/J-50~70	42	$\frac{7}{8}$ -10	12	24
T/J-90~120	45	$\frac{15}{16}$ -12	14	26
T/J-150~185	60	$1\frac{1}{8}$ -12	18	30
T/J-200~240	62	$1\frac{3}{16}$ -12	20	32

● **Stainless Steel Strap & Cable Ties**

● **Band Strap**

Main features:

1. Stainless steel has good anti-corrosion and anti-oxidation functions, and different grades of stainless steel can adapt to various environments;
2. The surface of the steel strip is marked with a metric mark every 10cm. The user can use the mark to accurately measure the required length, improve construction efficiency and reduce waste.
3. It needs to be used with stainless steel buckles. It can be used in various sizes for different environments and tension requirements. In theory, it can provide up to 1.5 tons of bundle tension.
4. Usually use economical carton packaging, users can also choose portable plastic box packaging, easy to carry out emergency maintenance and high-altitude operation of the facility.



- **Normal Size SS Band Strap**

Width		Thickness		Breaking Load	Package
Inch	(mm)	Inch	(mm)		
1/4	6.40	0.020	0.50	500	30m/roll
3/8	9.50	0.025	0.64	900	
1/2	12.7	0.030	0.76	1500	
5/8	16.0	0.030	0.76	1875	
3/4	19.0	0.030	0.76	2250	

Note: We also can package the ban strap according to your needs.

- **0.70mm Series SS Band Strap**

Width		Thickness		Breaking Load	Package
Inch	(mm)	Inch	(mm)		
1/4	6.40	0.028	0.70	500	30m/roll
3/8	9.50	0.028	0.70	900	
1/2	12.7	0.028	0.70	1500	
5/8	16.0	0.028	0.70	1875	
3/4	19.0	0.028	0.70	2250	

Note: We also can package the ban strap according to your needs.

● **Band Strap Installation**



1. Cut a length of stainless steel cable tie according to the actual use, put the buckle to one end of the cable tie and reserve a length of about 5cm.



2. Bend the reserved cable tie to fix the stainless steel buckle.



3. Put the another end of the stainless steel cable tie as picture shows, and set aside 10cm for the tool to use when tightening the cable tie.



4. Tie the straps with the strap presser and start to shake the straps slowly to tighten the straps to ensure that the straps are tight.



5. When the cable tie is tightened, fold the whole of the tight belt back, and then pull the handle of the tight belt blade to cut off the cable tie.



6. Hammer the two corners of the buckle with a hammer to catch the last reserved tie head.

● **Buckle**



- **Teeth Buckle**

Type	Width		Thickness (mm)
	Inch	(mm)	
KW-BT1	1/4	6.40	0.7
KW-BT2	3/8	9.50	0.7
KW-BT3	1/2	12.7	0.8
KW-BT4	5/8	16.0	0.8
KW-BT5	3/4	19.0	1.0



- **L Type Buckle**

Type	Width		Thickness (mm)
	Inch	(mm)	
KW-BL1	1/4	6.40	0.7
KW-BL2	3/8	9.50	0.7
KW-BL3	1/2	12.7	0.8
KW-BL4	5/8	16.0	0.8
KW-BL5	3/4	19.0	1.0

• **SS Cable Ties**

**- 4.6mm Self-locking Stainless Steel Cable Ties**

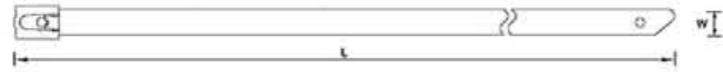

- Using Temperature: -80 C ~ +538 C  
- Maximum Tensile Strength: 800N (180lbs)

Width		Thickness		Length		Max Bundle Range	
Inch	mm	Inch	mm	Inch	mm	Inch	mm
0.18	4.6	0.01	0.25	5.90	150	1.40	35
0.18	4.6	0.01	0.25	7.90	200	2.00	50
0.18	4.6	0.01	0.25	9.80	250	2.60	65
0.18	4.6	0.01	0.25	11.80	300	3.10	80
0.18	4.6	0.01	0.25	13.80	350	3.70	95
0.18	4.6	0.01	0.25	15.70	400	4.30	110
0.18	4.6	0.01	0.25	17.70	450	4.90	125
0.18	4.6	0.01	0.25	19.70	500	5.50	140
0.18	4.6	0.01	0.25	21.7	550	6.30	160
0.18	4.6	0.01	0.25	23.60	600	6.70	170
0.18	4.6	0.01	0.25	25.60	650	7.70	195
0.18	4.6	0.01	0.25	27.90	700	8.30	210
0.18	4.6	0.01	0.25	29.50	750	8.90	225
0.18	4.6	0.01	0.25	31.50	800	9.40	240
0.18	4.6	0.01	0.25	33.50	850	10.10	258
0.18	4.6	0.01	0.25	35.40	900	10.60	270
0.18	4.6	0.01	0.25	37.40	950	11.40	290
0.18	4.6	0.01	0.25	39.40	1000	11.80	300
0.18	4.6	0.01	0.25	41.30	1050	12.70	322
0.18	4.6	0.01	0.25	43.30	1100	13.30	338
0.18	4.6	0.01	0.25	47.20	1200	14.30	363
0.18	4.6	0.01	0.25	51.20	1300	15.80	401
0.18	4.6	0.01	0.25	55.10	1400	17.00	433
0.18	4.6	0.01	0.25	59.10	1500	18.30	465
0.18	4.6	0.01	0.25	63.00	1600	19.60	497
0.18	4.6	0.01	0.25	67.00	1700	20.80	529
0.18	4.6	0.01	0.25	70.90	1800	22.00	561
0.18	4.6	0.01	0.25	74.80	1900	23.30	592
0.18	4.6	0.01	0.25	78.70	2000	24.60	624



**-7.9mm Self-locking Stainless Steel Cable Ties**

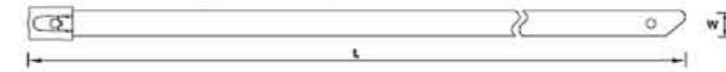

- Using Temperature: -80 C ~ +538 C  
- Maximum Tensile Strength: 1200N (270lbs)

Width		Thickness		Length		Max Bundle Range	
Inch	mm	Inch	mm	Inch	mm	Inch	mm
0.18	4.6	0.01	0.25	5.90	150	1.40	35
0.18	4.6	0.01	0.25	7.90	200	2.00	50
0.18	4.6	0.01	0.25	9.80	250	2.60	65
0.18	4.6	0.01	0.25	11.80	300	3.10	80
0.18	4.6	0.01	0.25	13.80	350	3.70	95
0.18	4.6	0.01	0.25	15.70	400	4.30	110
0.18	4.6	0.01	0.25	17.70	450	4.90	125
0.18	4.6	0.01	0.25	19.70	500	5.50	140
0.18	4.6	0.01	0.25	21.7	550	6.30	160
0.18	4.6	0.01	0.25	23.60	600	6.70	170
0.18	4.6	0.01	0.25	25.60	650	7.70	195
0.18	4.6	0.01	0.25	27.90	700	8.30	210
0.18	4.6	0.01	0.25	29.50	750	8.90	225
0.18	4.6	0.01	0.25	31.50	800	9.40	240
0.18	4.6	0.01	0.25	33.50	850	10.10	258
0.18	4.6	0.01	0.25	35.40	900	10.60	270
0.18	4.6	0.01	0.25	37.40	950	11.40	290
0.18	4.6	0.01	0.25	39.40	1000	11.80	300
0.18	4.6	0.01	0.25	41.30	1050	12.70	322
0.18	4.6	0.01	0.25	43.30	1100	13.30	338
0.18	4.6	0.01	0.25	47.20	1200	14.30	363
0.18	4.6	0.01	0.25	51.20	1300	15.80	401
0.18	4.6	0.01	0.25	55.10	1400	17.00	433
0.18	4.6	0.01	0.25	59.10	1500	18.30	465
0.18	4.6	0.01	0.25	63.00	1600	19.60	497
0.18	4.6	0.01	0.25	67.00	1700	20.80	529
0.18	4.6	0.01	0.25	70.90	1800	22.00	561
0.18	4.6	0.01	0.25	74.80	1900	23.30	592
0.18	4.6	0.01	0.25	78.70	2000	24.60	624



# Surge Arrester & Insulator

## Surge Arrester & Insulator

### Surge Arrester

- Features:
  - Reliability and excellent protection based on years of experience and expertise in surge protection.
  - Good anti-moisture capability, resistant to pollut
  - Long life and loghtweight.
  - Easy installation and maintenance.
  - High energy absorption ability.



Type	MOA Rated voltage	MOCV	1/10 $\mu$ S Step current impulse	8/20 $\mu$ S lightning current impulse	30/60 $\mu$ S switching current imoulse	2 $\mu$ S rectangular current impulse	4/10 $\mu$ S High current impulse
	kV(r.m.s)		> kv			A	kA
YH5W-3	3	2.55	11.3	9	8.9	150	65
YH5W-6	6	5.1	22.6	18	16.8	150	65
YH5W-9	9	7.65	33.7	27	23.8	150	65
YH5W-10	10	8.4	36	30	26.4	150	65
YH5W-11	11	9.4	40	33	30	150	65
YH5W-12	12	10.2	42.2	36	31.7	150	65
YH5W-15	15	12.7	51	45	38.5	150	65
YH5W-18	18	15.3	61.5	54	46.5	150	65
YH5W-21	21	17	71.8	63	54.5	150	65
YH5W-24	24	19.5	82	72	62.6	150	65
YH5W-27	27	22	92	81	69.8	150	65
YH5W-30	30	24.4	102	90	79	150	65
YH5W-33	33	17.5	112	99	86.7	150	65
YH5W-36	36	19	123	108	92.4	150	65
YH10W-3	3	2.55	11.3	9	8.9	250	100
YH10W-6	6	5.1	22.6	18	16.8	250	100
YH10W-9	9	7.65	33.7	27	23.8	250	100
YH10W-10	10	8.4	36	30	26.4	250	100
YH10W-11	11	9.4	40	33	30	250	100
YH10W-12	12	10.2	42.2	36	31.7	250	100
YH10W-15	15	12.7	51	45	38.5	250	100
YH10W-18	18	15.3	61.5	54	46.5	250	100
YH10W-21	21	17	71.8	63	54.5	250	100
YH10W-24	24	19.5	82	72	62.6	250	100
YH10W-27	27	22	92	81	69.8	250	100
YH10W-30	30	24.4	102	90	79	250	100
YH10W-33	33	27.5	112	99	86.7	250	100
YH10W-36	36	29	123	108	92.4	250	100

● **Insulator**

- This Product is special for badly polluted areas, high mechanical tension load, long span and compact power line, and have features of light weight, small volume, unbreakable, anti-bend. High strength high strength wrest resistant and strong explosion protection.

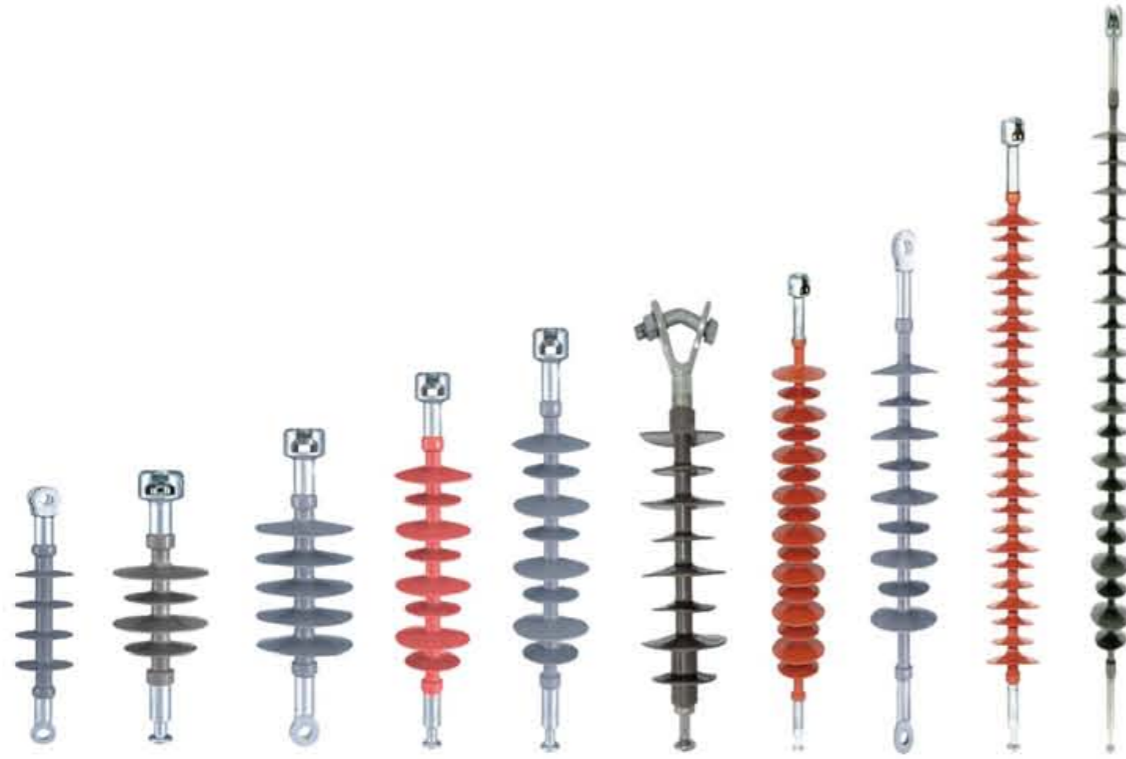

Model	Rated Voltage (kV)	Breaking Load (kN)	Length (mm)	Insulation Height (mm)	Creepage Distance (mm)	Umbrella Diameter (mm)	1min power frequency wet withstand voltage(kV)	Full wave lightning impulse withstand voltage (peak value) (kV)
FPQ-24/4	24	4	335	273	655	146/112	60	125
FPQ-24/6	24	6	310	210	535	120	60	125
FPQ-36/5	36	5	450	340	950	145/115	95	230
FXBW2-12/70UD	12	70	350	180	360	98/88	95	105
FXB2-15/70UD	15	70	375	200	470	98/88	42	105
FXB2-24/70UD	24	70	430	290	680	98	42	150
FXB2-28/70UD	28	70	430	290	680	98	95	230
FXB2-33/70UD	33	70	550	360	720	98	95	230
FXB2-35/70UD	36	70	570	400	1000	76	95	230
FXBO2-36/70	36	70	650	450	720	98	95	230

# Waterproof Junction Box





● **KW-RA/RT Series Plastic Junction Box**

- Body Material : ABS
- Stopper Material : PVC
- Protection Level : IP65
- Certificate : CE,RoHs
- Application: Suitable for indoor and outdoor electric, communication, fire fighting apparatus, iron and steel smelting, petrochemical industry, electron, power system, railway, building, mine, air and sea port, hotel, ship, works, waste water treatment equipment, enviromental equipment and so on.



Installation :

1. Inside: There are the installation holes in the base for circuit board or din rail.
  2. Outside: The products can be directly fixed on the wall or other flat boards with screw or nails via the screw holes in the base.
- Outlet Hole : Cutting a hole in the PVC stopper as related cable size or installing cable gland to get better waterproof performance.

Model	Size(mm)	IP	Hole Qty	Hole size (mm)	G.W. (KG)	PCS (CTNS)	CTN Specification (CM)
KW-RA/RT	50*50	55	4	25	13.5	300	46*38*51
	80*50	55	4	25	14.7	240	53*35*62
	85*85*50	55	7	25	17.2	200	53*41*53
	100*100*70	65	7	25	14.9	100	62*49*35
	150*110*70	65	10	25	15.1	60	67*33*46.5
	150*150*70	65	8	25	16.3	60	84.5*34*45
	200*100*70	65	8	25	16.6	60	61*46*42
	200*155*80	65	10	36	14.5	40	69.5*43.5*41
	200*200*80	65	12	36	18	40	90*46*40.5
	255*200*80	65	12	36	21.9	40	55*45*80
	255*200*120	65	12	36	21.9	30	64*55*62
	300*250*120	65	12	36	20.3	20	61.5*55.5*63
400*350*120	65	16	36	15	10	74.5*42.5*61.5	

● **KW-F Series Plastic Junction Box**

- Body Material : ABS or PC
- Protection Level : IP65
- Certificate : CE,RoHs
- Application : Suitable for indoor and outdoor electric, communication, fire fighting apparatus, iron and steel smelting, petrochemical industry, electron, power system, railway, building, mine, air and sea port, hotel, ship, works, waste water treatment equipment, enviromental equipment and so on.



Installation :

1. Inside : There are the installation holes in the base for circuit board or din rail.
2. Outside : The products can be directly fixed on the wall or other flat boards with screw or nails via the screw holes in the base.

Model	LxWxH (mm)	Model	LxWxH (mm)	Model	LxWxH (mm)
KW-F1	200x120x75	KW-F7	158x90x46	KW-F19 with ear	83x58x33
KW-F1-1	200x120x113	KW-F7-1	158x90x60	KW-F19-1	83x58x33
KW-F1-2 with ear	200x120x75	KW-F8 with ear	115x85x35	KW-F20	63x58x35
KW-F1-3	200x120x56	KW-F9	280x195x135	KW-F20-2 with ear	63x58x35
KW-F1-6 with ear	200x120x67	KW-F9-3	280x195x86	KW-F21	240x160x90
KW-F2	158x90x60	KW-F10-3	320x240x60	KW-F21-1	240x160x120
KW-F2-2 with ear	158x90x64	KW-F10	320x240x110	KW-F22	160x110x90
KW-F2-3	158x90x40	KW-F10-1	320x240x140	KW-F24	192x188x100
KW-F3	115x90x55	KW-F10-2	320x240x155	KW-F24-2	195x188x70
KW-F3-2	115x90x55	KW-F11-3	380x260x70	KW-F25	83x81x56
KW-F3-3 with ear	115x90x68	KW-F11	380x260x105	KW-F34	290x210x60
KW-F4	100x68x50	KW-F11-4	380x260x85	KW-F36	290x210x100
KW-F4-1 with small ear	100x68x40	KW-F11-1	380x260x120	KW-F50	300x280x140
KW-F4-2 with ear	100x68x50	KW-F11-2	380x260x140	KW-F51	390x290x165
KW-F5-1	160x160x70	KW-F13 with ear	120x81x65	KW-F51B	390x290x165
KW-F5	160x160x90	KW-F14	120x120x95	KW-K2	250x170x120
KW-F5-2 with ear	160x160x90	KW-F15	230x150x85	KW-K6	125x100x52
KW-F6	236x182x95	KW-F15-1	230x150x87	KW-K11	300x270x112
KW-F6-1	263x182x60	KW-F15-2 with ear	230x150x87		
KW-F6-2	263x182x125	KW-F16	160x45x55		

● **KT Series Plastic Junction Box**

- Body Material : ABS or PC
- Protection Level : IP67
- Protection Level : IP65
- Certificate : CE, RoHs

Application : Suitable for indoor and outdoor electric, communication, fire fighting apparatus, iron and steel smelting, petrochemical industry, electron, power system, railway, building, mine, air and sea port, hotel, ship, works, waste water treatment equipment, enviromental equipment and so on.

Installation :

1. Inside : There are the installation holes in the base for circuit board or din rail (more than 2pcs of M4 brass nuts have been in each box).

2. Outside : The products can be directly fixed on the wall or other flat boards with screw or nails via the screw holes in the base.

Outlet Hole : Holes can be opened on the box as customers' requirements, and installing cable gland can bring with better waterproof performance.



Size	Model		Size	Model	
(mm)	Solid Cover	Transparent Cover	(mm)	Solid Cover	Transparent Cover
65x50x55	KW-AG-0506	KW-AT-0506	175x125x75	KW-AG-1217-S	KW-AT-1217-S
95x65x55	KW-AG-0609	KW-AT-0609	170x120x100	KW-AG-1217	KW-AT-1217
110x80x45	KW-AG-0811-S	KW-AT-0811-S	175x125x100	KW-AG-1217-1	KW-AT-1217-1
110x80x70	KW-AG-0811	KW-AT-0811	170x140x95	KW-AG-1417	KW-AT-1417
110x80x85	KW-AG-0811-1	KW-AT-0811-1	150x150x120	KW-AG-1515-1	KW-AT-1515-1
100x100x75	KW-AG-1010	KW-AT-1010	175x175x100	KW-AG-1717-1	KW-AT-1717-1
130x80x70	KW-AG-0813	KW-AT-0813	200x150x75	KW-AG-1520-S	KW-AT-1520-S
130x80x85	KW-AG-0813-1	KW-AT-0813-1	200x150x100	KW-AG-1520	KW-AT-1520
160x80x55	KW-AG-0816-S	KW-AT-0816-S	200x150x130	KW-AG-1520-1	KW-AT-1520-1
180x80x70	KW-AG-0818	KW-AT-0818	250x150x100	KW-AG-1525	KW-AT-1525
180x80x85	KW-AG-0818-1	KW-AT-0818-1	250x150x130	KW-AG-1525-1	KW-AT-1525-1
250x80x70	KW-AG-0825	KW-AT-0825	200x200x95	KW-AG-2020-S	KW-AT-2020-S
250x80x85	KW-AG-0825-1	KW-AT-0825-1	200x200x130	KW-AG-2020	KW-AT-2020
125x125x75	KW-AG-1212-S	KW-AT-1212-S	280x190x130	KW-AG-2819	KW-AT-2819
120x120x100	KW-AG-1212	KW-AT-1212			

● **Customized Junction Box**



● **How to Installation Plastic Junction Box**



The first : as shown in the big picture, can be installed directly by screw can be fixed on the cover.



The Second : the top, as shown in the figure in a waterproof installation approach move to fixed with this department.